

MODEL 203.0 /2 /7 up to 31.5.01 with CODE (580) Air conditioning (or Tempmatic for USA)
MODEL 203.0 /2 /7 as of 1.6.01 with CODE (580) Automatic air conditioning
MODEL 203.0 /2 /7 as of 24.4.04 except CODE (581) Comfort automatic air conditioning

- M2/5 Fresh air/air recirculation flaps actuator motor
- M2/6 Left blending air flap actuator
- M2/7 Right blending air flap actuator
- M2/15 Left and right footwell flaps actuator motor
- M2/16 Left and right defroster flaps actuator motor
- M2/21 Fresh air flaps actuator motor

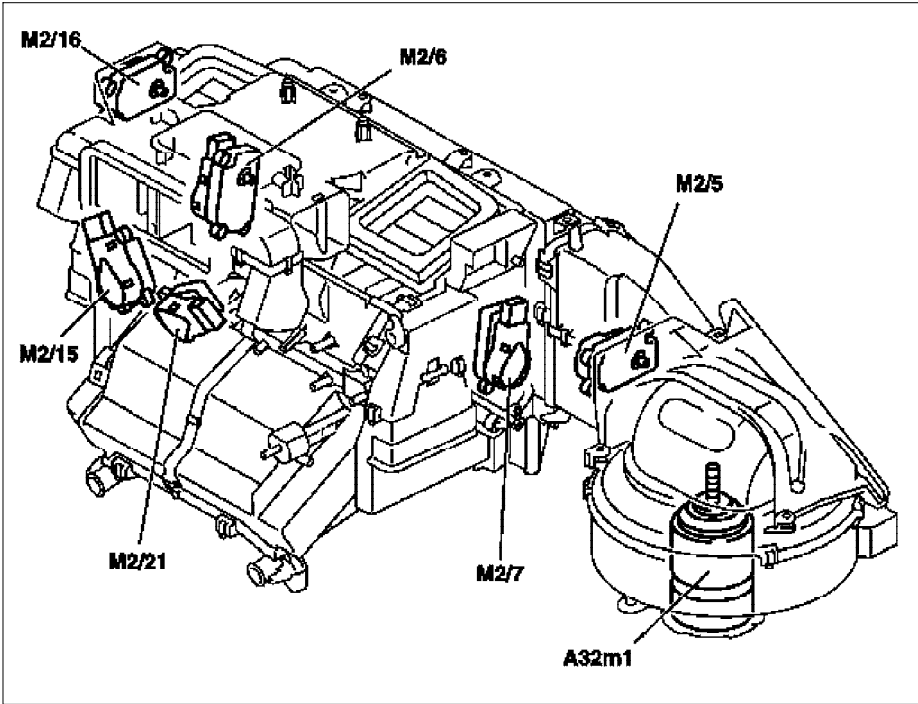

P83.40-2192-06

	Automatic air conditioning actuator motors, location	The actuator motors (M2/5, M2/6, M2/7, M2/15, M2/16, M2/21) are on the A/C housing.	
	Automatic air conditioning actuator motors, task		GF83.40-P-2182-01P
	Automatic air conditioning actuator motors, function		GF83.40-P-2182-02P